

# T400 Series Option

## Laser Guide

Provides reference to enable cut accuracy (not shown)

## Pneumatic Blade Guard

Protects blade at adjustable heights via pneumatic actuation (not shown)

## Last Slice Device

Holds protein firmly for repetitive cutting to last slice when sliding table in use

## Table Options

- Sliding table
- Fixed table
- Custom - On request

## Adjustable Fence Bar Graduated Scale

Enables consistency using adjustable scale

## Air Filter/Dryer Membrane

Protects and filters contaminants in pneumatic supply (not shown)

## Emergency Knee Stop

Offers alternatives preferences (not shown)

## Castors, if desired

Enables mobility (not shown)

## Stainless Steel Adjustable Feet

Enables machine stability and ergonomic adjustments for operator height

## BladeStop Connect

IOT integration providing real-time data for efficient operations and training

## Configuration

Configures for left or right handed operators, not both, or side to side (R to L)



# STOPS FASTER. FULL STOP.

**bladestop.com**

bladestop@scottautomation.com

**BLADESTOP**  
powered by SCOTT

**The fastest stopping time on the market—because when a limb is on the line, every millisecond counts.**

## MECHANICAL

Wheel Diameter	430 mm [17"]
Blade Size	5/8" x 3TPI x 3290 mm [5/8" x 3TPI x 10'8"]
Blade Speed	1524-2286 m/min [5K-7.5K feet/min]
Shipping Weight	560 kg [1235 lbs.]
Mobility Options	Castor Wheels, Adjustable Feet

## ELECTRICAL

Motor Voltage - 3 phase, 50/60 Hz	208-575 VAC
Motor Power/Protection Class	3 KW [4 HP]/IP55
Motor Efficiency	Class IE 3
Full Load Current	13.4/6.4 A
Connector Type	IP 66 rated, 4 pin 3 phase 20-40 Amp
Motor Brake	Standard - Friction

## PNEUMATICS

Supply Pressure	6-7.5 Bar [85-105 psi]
Flow Rate	260 L/min

## DIMENSIONS

Max cut height	421 mm [1'4"]
Max throat depth	390 mm [1'3"]
Cutting stroke (front of table to blade)	358 mm [1'2"]
Machine Dimensions (WxDxH)	1133 x 1092 x 2018 mm [3'7" x 3'6" x 6'6"]
Table Dimensions (WxDxH)	901 x 936 x 986 mm [2'9" x 3'1" x 3'2"]

## REGIONAL COMPLIANCE

Standards	UL (USA & Canada) CE Certified ASNZ 4024 ASNZ 3000
-----------	---

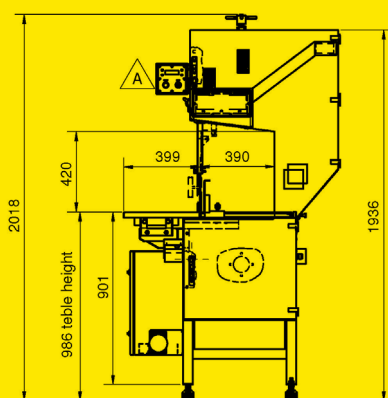

FRONT VIEW

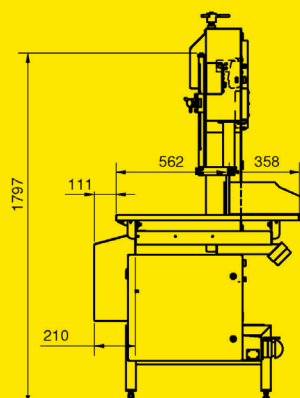

SIDE VIEW

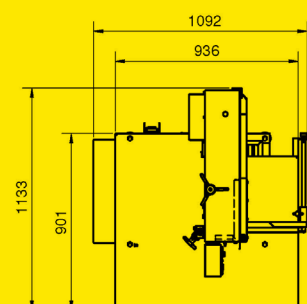

TOP VIEW